

Accessories

Z18-0

Z18-1

Z18-2

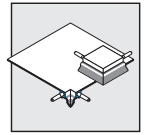
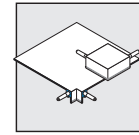
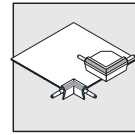

APU Corner Element

accessory for Border Profile W40, Base Rail System W60/W61 and Base Edge Profile W66

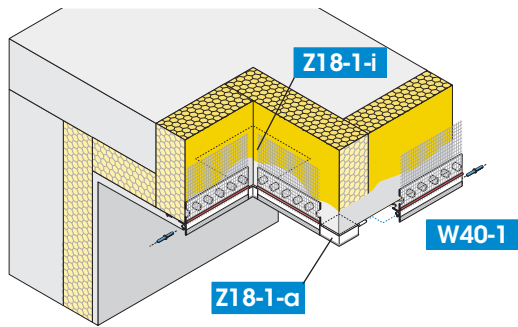

Corner Element Z18-1 in this case at Border Profile DROP-TEX-UNO W40-1

the Corner Element can be trimmed with Shears (Z12) to fit as required.

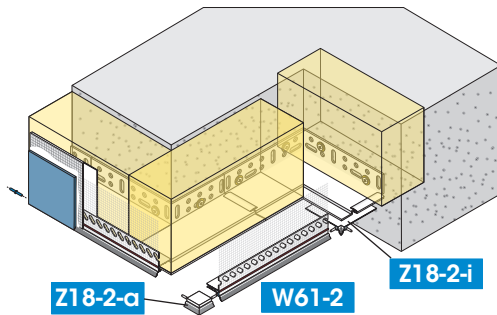
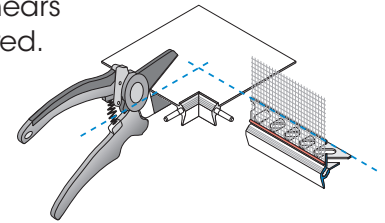

Corner Element Z18-2 in this case at Base Rail System SOLI-TEX-UNO W61-2

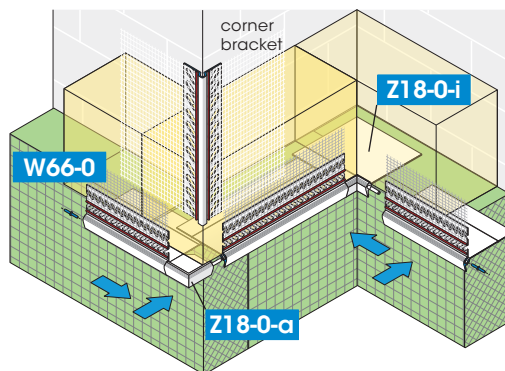

Corner Element Z18-0 in this case at Base Edge Profile SOKA-TEX-UNO W66-0

Using the Corner Elements Z18 for inner/outer corners neat and exact corners can be made easily and quickly. The plug-in pins on the right and left of the Corner Elements are inserted into the profiles W40, W61 or W66 being placed. So all profile edges form a flush aligned border with each other.

Available packed unit:

10 bags of 10 pieces per pack

Order No.:

Z18-0-a		Z18-1-a		Z18-2-a
Z18-0-i		Z18-1-i		Z18-2-i